

### Bloques de premontaje y contraplacas

Los bloques de premontaje y las contraplacas deben solicitarse por separado.

### Pre-installation dies and backing-plates

Pre-installation dies and backing-plates have to be ordered separately.

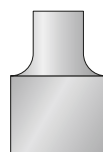

bloque premontaje  
Pre-installation dies

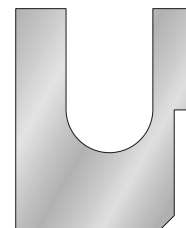

contraplacas  
backing-plates

tubo Ø ext. o.d. tube	bloque premontaje pre-installation die	contraplacas para anillos cortantes backing-plates for cutting rings	contraplacas para anillos de doble arista backing-plates for double-bite
			
6L	8M07L06 00	8M08 06 00	8M09 06 00
6S	8M07S06 00	8M08 06 00	8M09 06 00
8L	8M07L08 00	8M08 08 00	8M09 08 00
8S	8M07S08 00	8M08 08 00	8M09 08 00
10L	8M07L10 00	8M08 10 00	8M09 10 00
10S	8M07S10 00	8M08 10 00	8M09 10 00
12L	8M07L12 00	8M08 12 00	8M09 12 00
12S	8M07S12 00	8M08 12 00	8M09 12 00
14	8M07 14 00	8M08 14 00	8M09 14 00
15	8M07 15 00	8M08 15 00	8M09 15 00
16	8M07 16 00	8M08 16 00	8M09 16 00
18	8M07 18 00	8M08 18 00	8M09 18 00
20	8M07 20 00	8M08 20 00	8M09 20 00
22	8M07 22 00	8M08 22 00	8M09 22 00
25	8M07 25 00	8M08 25 00	8M09 25 00
28	8M07 28 00	8M08 28 00	8M09 28 00
30	8M07 30 00	8M08 30 00	8M09 30 00
35	8M07 35 00	8M08 35 00	8M09 35 00
38	8M07 38 00	8M08 38 00	8M09 38 00
42	8M07 42 00	8M08 42 00	8M09 42 00

### Soporte para la colocación de los bloques de premontaje y contraplacas

Holder for storage of pre-installation dies and backing-plates

